

LUKE GOGGIN REAL ESTATE



29 Park Street Strathdale VIC

2 2 1

This generously proportioned & unique home set on 787m² (approx) in a highly sought after location, offers fantastic spacious rooms & abundant natural light provided by floor to ceiling windows. From the wide entrance hall, step down into the open plan living space. Entertaining is a dream with 2 lounge areas containing built in cabinetry & a bar. The dining area flows into the kitchen which has ample cupboards & bench space, double sinks & an electric wall oven & cooktop. Glass sliding doors at each end lead outside to the low maintenance courtyard featuring established plants & water ponds. Both bedrooms contain built in robes, the main with an ensuite. The family bathroom provides a sliding door through to a separate toilet which can also be accessed from the laundry. Other features include wooden beams, original light fittings & decorative wallpaper & impressive floor to ceiling storage in the hallway. A split system, ceiling fans & 2 gas heaters

Price : \$ 400,000
Land Size : 787 sqm
View : <https://www.goggin.com.au/sale/vic/greater-bendigo-region/strathdale/residential/house/5725530>



Melinda Goggin
03 5442 1422

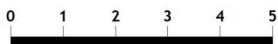
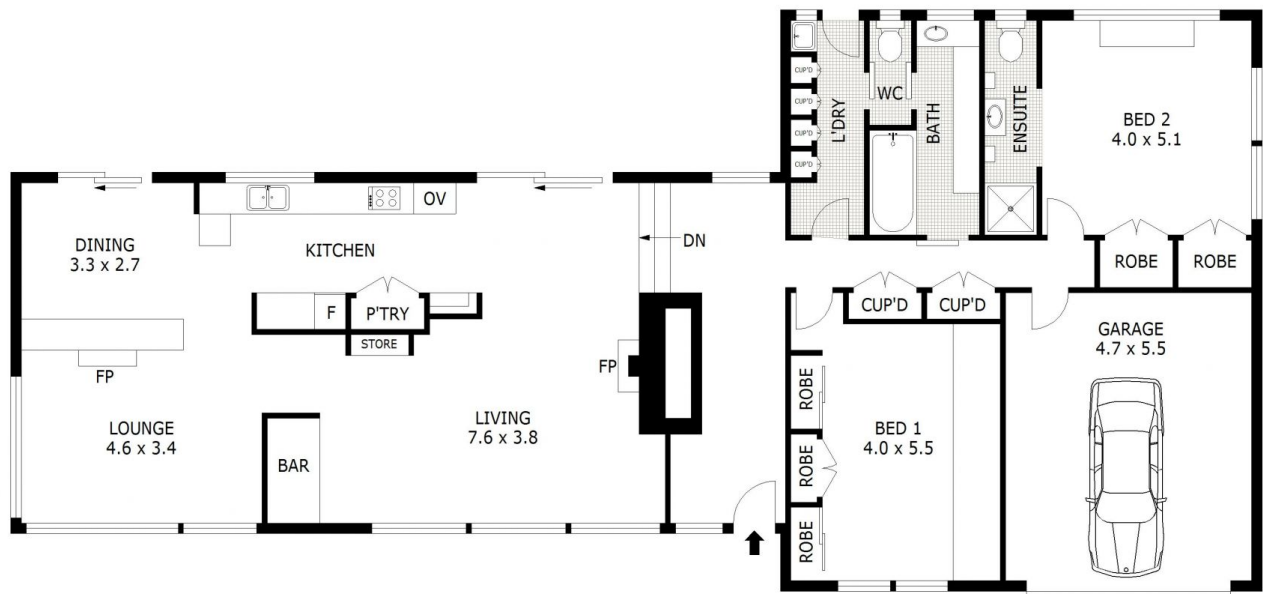

Scale in metres. Indicative only. Dimensions are approximate. All information contained herein is gathered from sources we believe to be reliable. However we cannot guarantee its accuracy and interested parties should rely on their own enquiries.

Residence	- 163 m ²
Garage	- 26 m ²
Total	- 189 m ²

9 Park Street, Strathdale